

Patio Home

2 Bedroom, 2 Bath, 674 sq. ft.

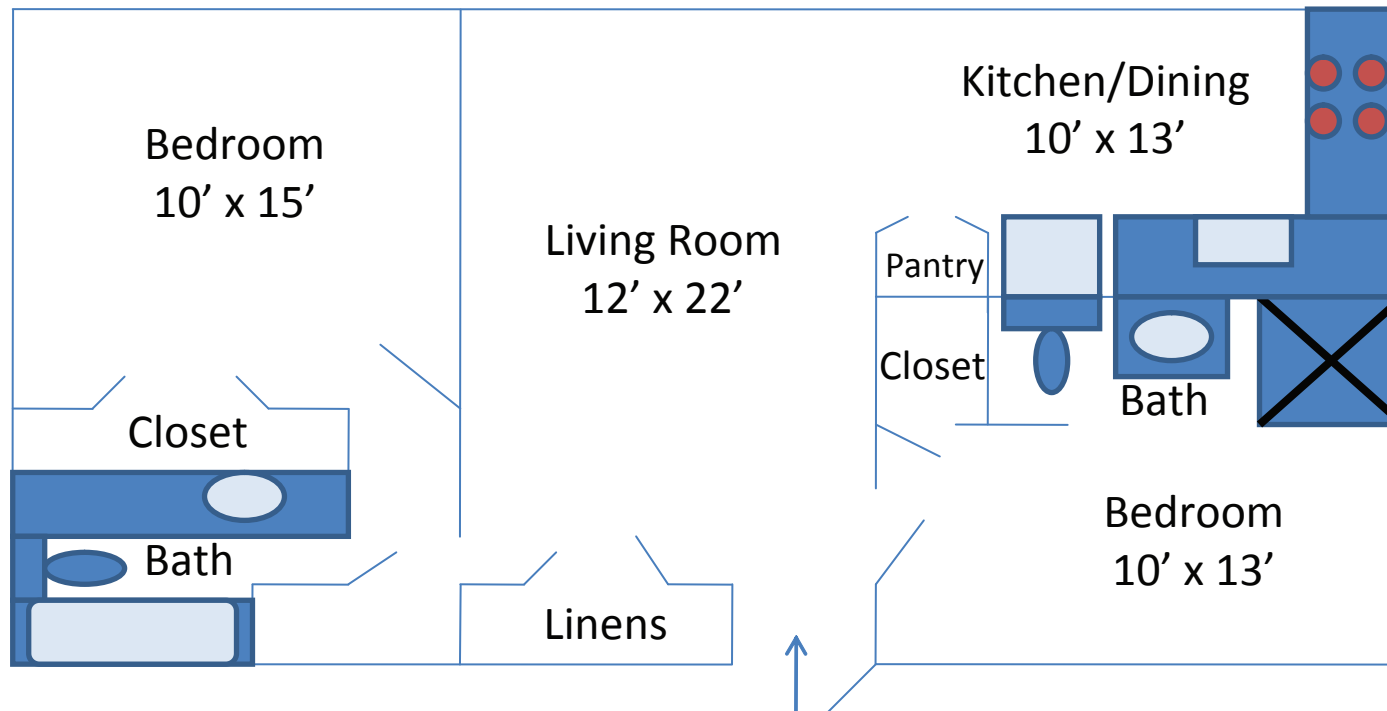

Services:

- Mid-day meal
- Consultation with Nurse and Dietician
- Scheduled transportation for shopping
- Cable television
- Mail service

- 24-hour emergency call
- Laundry facilities
- Social/Recreational/Religious programs
- Property and liability insurance
- Building and grounds maintenance